



KRASOflex® Construction Joint Tapes

KRASOflex® 155 (p. 135) + Duo-Fix 150 „plus“ (p. 136) + Construction Joint-Wall Element AFW 150 (p. 139) + KM-Band (p. 139) + Joint Tape A (p. 146) + Joint Tape ASI (p. 146) + Joint Tape AA (p. 147)

KRASOflex® Expansion Joint Tapes

Joint Tape AD (p. 147) + Joint Tape D (p. 147)

KRASOflex® Star Tubes

Star Tube Basis (p. 138) + Star Tube System (p. 139)

KRASOflex® Joint Plate ZVB

Joint Plate ZVB (p. 140) + Joint Plate ZVB - Desired Crack Elements (p. 141) + Formwork Elements (p. 142) + Bento-nit Expansion Joint Tape (p. 143) + Expansion Rubber (p. 143)

KRASOflex® Moulded Parts

Building Expansion Joint T1 (p. 148) + Building Expansion Joint T2 (p. 148) + Construction Joint T3 (p. 149) + Wall Expansion Joint T4 (p. 149) + Building Expansion Joint T5 (p. 149) + Construction Joint T6 (p. 149)

KRASOflex® Clamp Constructions

Clamp Constructions (p. 150) + Clamp Constructions - Accessories (p. 150)

KRASOflex® Accessories

Mounting Clamp (p. 136) + Sealing Strip (p. 136)

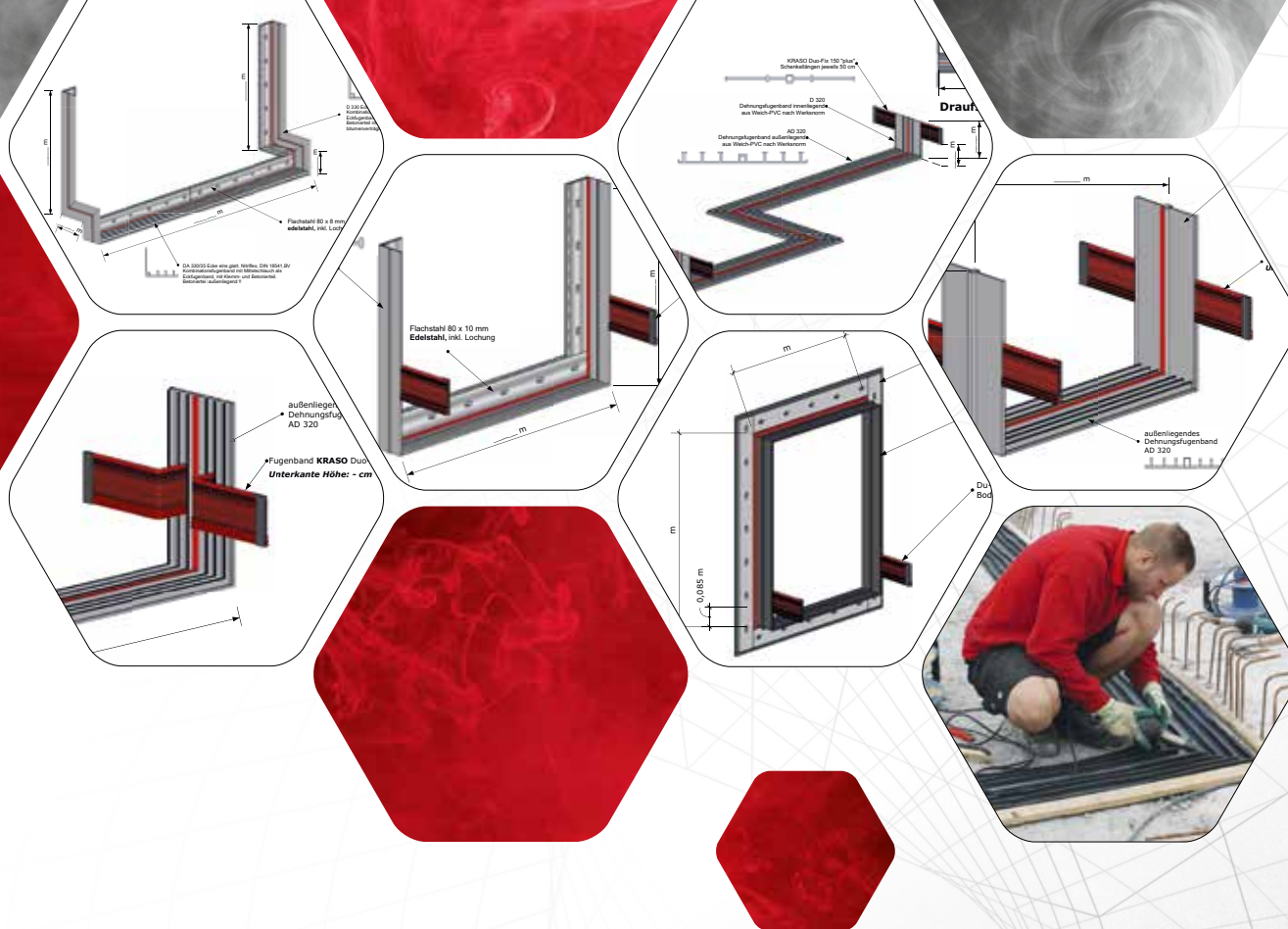

KRASO® Joint Tape Service from A to Z

Production, packaging, installation

- + **Our experience, your advantage:** we refer to your formwork and design plans for dimensions, lengths and the type of joints and develop the **appropriate solution for effective joint sealing**.
- + The production takes place under **ideal conditions** in our factory: independent of weather conditions and free of contamination. On-time delivery avoids unnecessarily long storage times on-site.
- + **Advice, measurement and installation on-site!**

„Huge construction projects require precise planning - also with regard to the various joints and the connection of existing components. With our experience and manufacturing expertise, we are at your side from the very beginning!“ Tim Weyer, Projects / Engineering

We look forward to your enquiry!

- + +49(0)28 72 -95 35-0
- + WhatsApp +49(0)28 72 - 95 35-888
- + projekte@kraso.de



The joint plate made of plastic

Connections can easily be created on-site with our **KRASOflex®** Joint Connectors



The visual check helps to avoid installation errors

KRASOflex® 155 can easily be adapted and bent due to the inner core

WU
1+2

NEUBAU

KRASOflex®
Splicing Set



KRASOflex® 155

The joint plate made of plastic

- + As stable as a joint plate – flexible like a joint tape! Thanks to the inner plastic core, the **KRASOflex® 155** can easily be bent and adjusted.
- + For installation on the upper reinforcement layer – **only 3 cm of integration into the concrete required during the first concreting step.** Optimal visual check due to visual control strip in different colour.
- + Including **splicing set** for a quick and easy splicing.
- + Easy fixation due to punched eyelets.
- + **DafStB waterproof concrete guideline: stress class 1 + 2**

KRASOflex® 155 **LG 4**

| Type / Item | KRASOflex® 155 |
|-----------------------|-------------------------|
| Roll length / width | 25 m / 150 mm |
| Weight per roll | approx. 20 kg |
| KRASOflex® 155 | 7.70 € per metre |

Scope of supply: **KRASOflex® 155**, splicing set consisting of plastic mounting bracket, plastic adhesive, 2 joint tape clips

KRASOflex® 155 - Splicing Set **LG 4**

for **KRASOflex® 155**, for the creation of further splicing

| Type / Item | KRASOflex® 155 - Joint Tape Clip Set |
|--------------------------------------|--------------------------------------|
| KRASOflex® 155 - Splicing Set | 9.90 € |

Scope of supply: **KRASOflex® 155 - Splicing Set** consisting of plastic mounting bracket, plastic adhesive, 2 joint tape clips



KRASOflex® Joint Tape Duo-Fix 150 „plus“
Check the installation video
(just scan the QR code!)

**Stable like a
joint plate –
flexible like
a joint tape!**

KRASOflex® Mounting Clamp
for securing the impact joint!



Splicing can be created easily
with **KRASOflex®**
sealing strips on-site



KRASOflex® Duo-Fix 150 „plus“ can easily
be adapted and bent due to the
inner core

ABP

NEUBAU

**WU
1+2**

KRASOflex® Joint Tape Duo-Fix 150 „plus“ The technically high-quality construction joint tape

- + Stable like a joint plate – flexible like a joint tape!
KRASOflex® Duo-Fix 150 „plus“ can easily be adapted and bent due to the inner core.
- + For installation on the upper reinforcement layer – **only 3 cm of integration into the concrete required during the first concreting step.** Optimal visual control due to visual control strip in different colour.
- + Splicing can be created easily with **KRASOflex® Sealing Strips** on the construction-site.
- + Easy fixation due to punched eyelets.
- + DafStB waterproof concrete guideline: stress class 1 + 2

KRASOflex® Duo-Fix 150 „plus“ LG 4

| Type / Item | KRASOflex® Duo-Fix 150 „plus“ |
|--------------------------------------|--------------------------------------|
| Roll length / width | 25 m / 150 mm |
| Weight per roll | approx. 35 kg |
| KRASOflex® Duo-Fix 150 „plus“ | 10.95 € per metre |

KRASOflex® Mounting Clamps LG 4

for joint tapes and joint plates up to 20 cm height



| Type / Item | KRASOflex® Mounting Clamp | KRASOflex® Mounting Clamp for precast walls |
|----------------------------------|----------------------------------|--|
| KRASOflex® Mounting Clamp | 1.20 € | 1.20 € |

KRASOflex® Sealing Strips LG 4

for splicing, self-adhesive



| Type / Item | KRASOflex® Sealing Strips |
|------------------|----------------------------------|
| Roll (2.50 mtr.) | 4.60 € per metre |

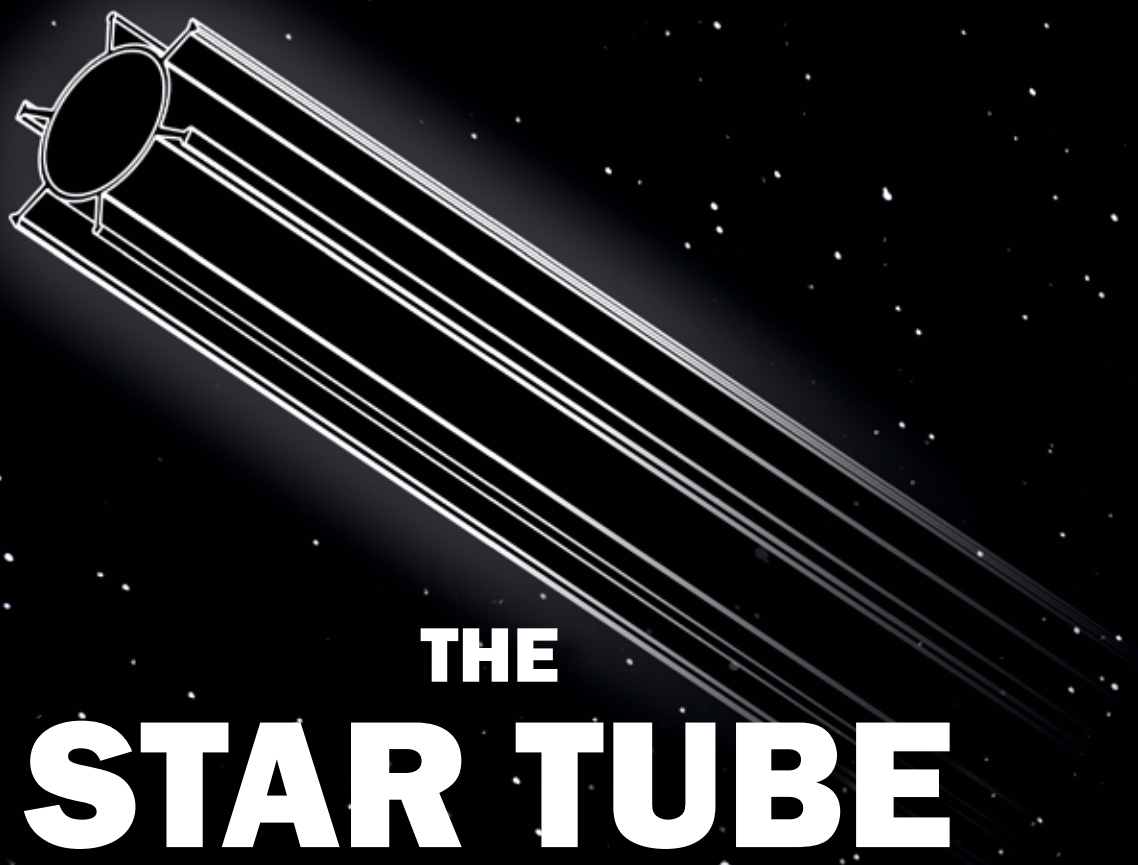

THE
STAR TUBE
OF THE FUTURE

WILL ENTER

MID 2024



KRASOflex® Star Tube System
Check the installation video
(just scan the QR code!)

KRASOflex® Star Tube Basis –
slot 15 x 50 mm
next concreting step
KRASOflex® Joint Tape
ASI or on-site
joint tape / metalsheet
construction-joint

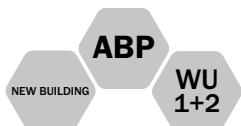
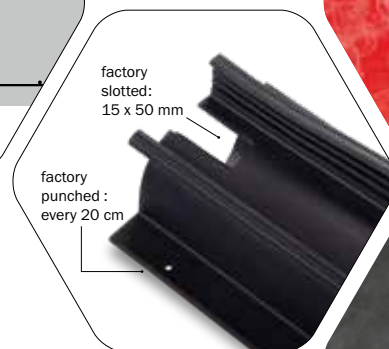
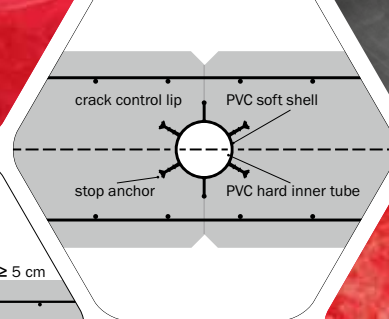
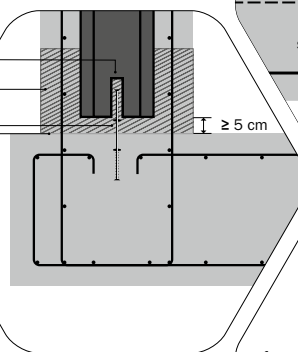

KRASOflex® Star Tube

Desired crack elements for precast and in-situ concrete walls

- + As crack inducer tubes for precast walls and in-situ concrete walls for joint or corner areas.
- + **KRASOflex® Star Tube Basis**: ready for immediate installation on joint tapes or joint plates!
- + **Factory slotted!**
- + **Factory punched every 20 cm!**
- + **KRASOflex® Star Tube System FTW 60 or OBW 88**: with two fixation sides and mounting clamps – for placement on any joint tape or joint plate!
- + **DafStB waterproof concrete guideline: stress class 1 + 2**

KRASOflex® Star Tube Basis **LG 4**

for placement on joint tape or joint plate, universally usable for joint or corner areas of wall elements | **DafStB waterproof concrete guideline: stress class 1 + 2**

| Type / Item | KRASOflex® Star Tube Basis 60 • KRASOflex® Star Tube Basis 88 | | | | | | |
|--------------------------------------|---|---------|---------|---------|---------|---------|---------|
| Length | 2.50 m | 2.75 m | 3.00 m | 3.50 m | 4.00 m | 4.50 m | 5.00 m |
| KRASOflex® Star Tube Basis 60 | 41,75 € | 45,90 € | 50,10 € | 58,45 € | 66,80 € | 75,15 € | 83,50 € |
| KRASOflex® Star Tube Basis 88 | 48,00 € | 52,80 € | 57,60 € | 67,20 € | 76,80 € | 86,40 € | 96,00 € |

Further lengths available on request!

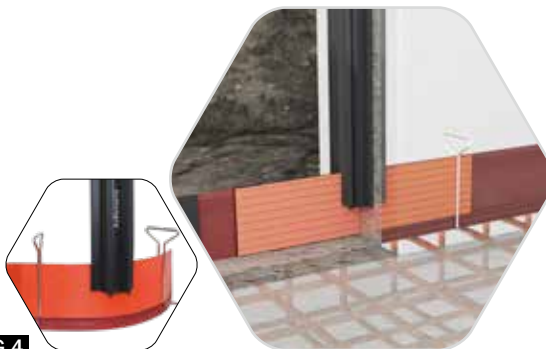
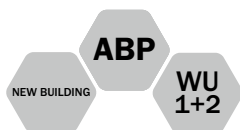

KRASOflex® Star Tube System **LG 4**

for placement on joint tape or joint plate, universally usable for joint or corner areas of wall elements
| DafStB waterproof concrete guideline: stress class 1 + 2

| Type / Item | KRASOflex® Star Tube System | | | | | | |
|--|-----------------------------|--------|--------|--------|--------|--------|--------|
| Length | 2.50 m | 2.75 m | 3.00 m | 3.50 m | 4.00 m | 4.50 m | 5.00 m |
| KRASOflex® Star Tube System FTW 60 (precast walls) | 86 € | 92 € | 95 € | 107 € | 120 € | 135 € | 146 € |
| KRASOflex® Star Tube System OBW 88 (in-situ walls) | 108 € | 116 € | 121 € | 135 € | 148 € | 164 € | 179 € |

Scope of supply: KRASOflex® Star Tube System incl. 50 cm fixing bracket and 2 pcs. KRASOflex® Mounting Clamps for easy fixation

Further lengths available on request!

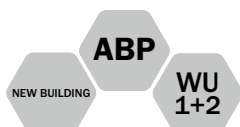

KRASOflex® AFW **LG 4**

construction joint wall element for vertical construction joints in the wall/wall joint area | DafStB waterproof concrete guideline: stress class 1 + 2

| Type / Item | KRASOflex® AFW | | | | | | |
|--------------------|----------------|--------|--------|--------|--------|--------|--------|
| Length | 2.50 m | 2.75 m | 3.00 m | 3.50 m | 4.00 m | 4.50 m | 5.00 m |
| KRASOflex® AFW 150 | 70 € | 74 € | 78 € | 83 € | 89 € | 96 € | 102 € |
| KRASOflex® AFW 155 | 63 € | 67 € | 70 € | 75 € | 80 € | 86 € | 92 € |

Scope of supply: KRASOflex® AFW incl. 50 cm fixing bracket and 2 pcs. KRASOflex® Mounting Clamps for easy fixation

Further lengths available on request!

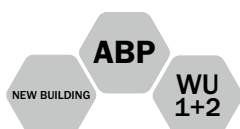

KRASOflex® KM-Band **LG 4**

internal construction joint tape – 120 or 150 mm width | DafStB waterproof concrete guideline: stress class 1 + 2

| Type / Item | KRASOflex® KM-Band | |
|---------------------|--------------------|------------------|
| Roll length / width | 25 m / 120 mm | 25 m / 150 mm |
| Weight per roll | approx. 17 kg | approx. 21 kg |
| KRASOflex® KM-Band | 6.30 € per metre | 7.10 € per metre |

KRASOflex®
Joint Plate ZVB
 - the one with mineral
 special coating

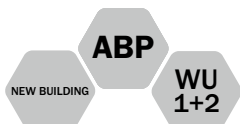

KRASOflex® Joint Plate ZVB

Cement-composite joint plate with mineral special coating

- + For the sealing of construction joints and controlled crack joints
- + Active-mineral special coating:
active and composite sealing combined in one joint plate!
- + System solutions for in-situ concrete and precast walls
- + No sticking, no protection foil and therefore less waste on the construction-site!
- + Installation independent of weather and season!
- + DafStB waterproof concrete guideline: stress class 1 + 2



KRASOflex® Joint Plate ZVB **LG 4**

| Type / Item | KRASOflex® Joint Plate ZVB 100 | KRASOflex® Joint Plate ZVB 150 |
|---|--------------------------------|--------------------------------|
| Height | 100 mm | 150 mm |
| Length | 2000 mm | 2000 mm |
| Packing Unit | 100 metres / box | 100 metres / box |
| KRASOflex® Joint Plate ZVB | 7.30 € per metre | 8.80 € per metre |
| KRASOflex® Joint Plate ZVB for industrial systems | Prices on request | Prices on request |
| KRASOflex® Joint Plate ZVB for agricultural systems | Prices on request | Prices on request |

Scope of supply: KRASOflex® Joint Plate ZVB, fixing clips (50 pcs./box)

KRASOflex® Joint Plate ZVB - Accessories **LG 4**

| Type / Item | KRASOflex® Joint Plate ZVB - Accessories | | | |
|---------------------------------|--|--|--|--|
| | KRASOflex® ZVB - Fixing Clip | KRASOflex® ZVB - Mounting Clamp 150 | KRASOflex® ZVB - Clamping Plate 150 | KRASOflex® ZVB - Corner 150 |
| Feature | Fixing clip for overlapping joints | Clamp for the installation on the reinforcement | Clamping plate for the connec- tion to expansion/construction joint tape | For the professional connection to precast corner elements |
| Packing Unit | 50 Stk. / bag | 25 Stk. / bag | - | - |
| KRASOflex® ZVB - Accessories | 19 € pro bag | 1.20 € per piece | 29.70 € per piece | 23.60 € per piece |

KRASOflex® Joint Plate ZVB - Desired Crack Elements Wall Cement-composite sheet with mineral special coating

- + For the controlled production and sealing at the same time of defined desired cracks in in-situ concrete and precast walls
- + DafStB waterproof concrete guideline: stress class 1 + 2

KRASOflex® Joint Plate ZVB - Desired Crack Elements OBW (in-situ concrete walls) **LG 4**

for the controlled production and sealing at the same time of defined desired cracks in in-situ concrete walls

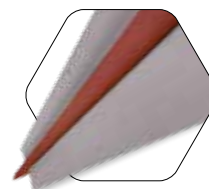

| Type / Item | KRASOflex® ZVB - desired crack joint element OBW 240/300 | KRASOflex® ZVB - desired crack joint element OBW 400 |
|--|--|--|
| Wall thickness | 240 - 300 mm | up to 400 mm |
| Length of element | 2,500 mm | 2,500 mm |
| KRASOflex® ZVB - desired crack element OBW | 42 € per metre | 46.50 € per metre |
| Type / Item | KRASOflex® ZVB - extension element for desired crack joints OBW 240/300 | KRASOflex® ZVB - extension element for desired crack joints OBW 400 |
| Wall thickness | 240 - 300 mm | up to 400 mm |
| Length of element | 1,000 mm | 1,000 mm |
| KRASOflex® ZVB - extension element for desired crack joints OBW | 42 € per metre | 46,50 € per metre |

Special sizes and elements for base plates available on request!

for the professional connection of FTW corner elements
see KRASOflex® ZVB - Corner 150
(p. 140, KRASOflex® Joint Plate ZVB - accessories)



KRASOflex® Joint Plate ZVB - Desired Crack Elements FTW (precast walls) **LG 4**

for the desired production and sealing of desired cracks in precast walls

| Type / Item | KRASOflex® ZVB - element for desired cracks FTW 240/250 - butt joint | KRASOflex® ZVB - element for desired cracks FTW 300 - butt joint |
|---|---|---|
| Wall thickness | 240 - 250 mm | 300 mm |
| Length of element | 2,500 mm | 2,500 mm |
| KRASOflex® ZVB - element for desired cracks FTW | 40,50 € per metre | 42 € per metre |
| Type / Item | KRASOflex® ZVB - extension element for desired cracks - FTW 240/250 - butt joint | KRASOflex® ZVB - extension element for desired cracks - FTW 300 butt joint |
| Wall thickness | 240 - 250 mm | up to 300 mm |
| Length of element | 1.000 mm | 1.000 mm |
| KRASOflex® ZVB - extension element for desired cracks FTW - butt joint | 40.50 € per metre | 42 € per metre |
| Type / Item | KRASOflex® ZVB - element for desired cracks FTW 240/250 - corner joint | KRASOflex® ZVB - element for desired cracks FTW 300 - corner joint |
| Wall thickness | 240 - 250 mm | 300 mm |
| Length of element | 2,500 mm | 2,500 mm |
| KRASOflex® ZVB - element for desired cracks FTW | 43.80 € per metre | 45 € per metre |
| Type / Item | KRASOflex® ZVB - extension element for desired cracks FTW 240/250 - corner joint | KRASOflex® ZVB - extension element for desired cracks FTW 300 corner joint |
| Wall thickness | 240 - 250 mm | up to 300 mm |
| Length of element | 1,000 mm | 1,000 mm |
| KRASOflex® ZVB - extension element for desired cracks FTW - butt joint | 43.80 € per metre | 45 € per metre |

Further lengths available on request!

KRASOflex® Formwork Elements

Sealing and formwork in the base, wall and roof area

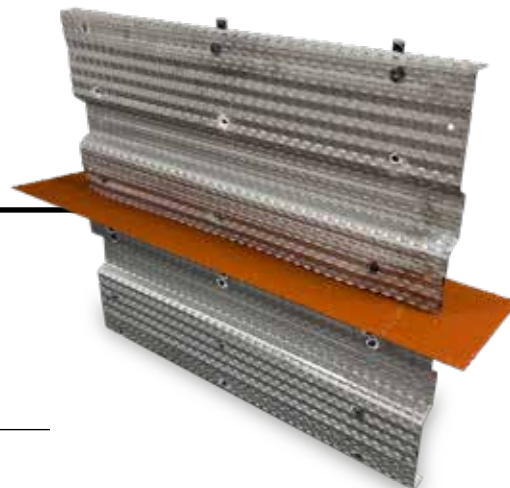

KRASOflex® Formwork Element ABS-R (rough) **LG 4**

Simultaneously shutter horizontal and vertical construction joints and make them watertight by installing the **KRASOflex® Joint Plate ZVB**. Joint type: rough.

Available in all standard sizes and in special designs! Prices on request!

KRASOflex® Formwork Element ABS-R-V (rough, reinforced) **LG 4**

Simultaneously shutter horizontal and vertical construction joints and make them watertight by installing the **KRASOflex® Joint Plate ZVB**. Joint type: rough, design: reinforced.

Available in all standard sizes and in special designs! Prices on request!

KRASOflex® Formwork Element ABS-V (interlocked) **LG 4**

Simultaneously shutter horizontal and vertical construction joints and make them watertight by installing the **KRASOflex® Joint Plate ZVB**. Joint type: interlocked according to EC2.

Available in all standard sizes and in special designs! Prices on request!

KRASOflex® Formwork Element ABS-V (interlocked, reinforced) **LG 4**

Simultaneously shutter horizontal and vertical construction joints and make them watertight by installing the **KRASOflex® Joint Plate ZVB**. Joint type: interlocked according to EC2, design: reinforced.

Available in all standard sizes and in special designs! Prices on request!

KRASOflex®
upstand elements
and moulds for the
formwork
on request!



KRASOflex® Bentonit Expansion Joint Tape

For the sealing of internal construction joints in in-situ concrete elements

- + Bentonit expansion joint tape for the sealing of geometrically difficult construction joints in the base area, wall and floor area
- + Strong, quick and reliable swelling reaction in contact with water. Suitable for water exchange zones!
- + Reliable sealing of joints in in-situ concrete constructions against permanent or temporary exposure by ground, slope and surface water
- + DafStB waterproof concrete guideline: stress class 1 + 2

KRASOflex® Bentonit Expansion Joint Tape **LG 4**

| Type / Item | KRASOflex® Bentonit Expansion Joint Tape |
|--|--|
| Dimension | 20 x 25 mm |
| Packing Unit | 5 metres per roll / 30 metres per box |
| KRASOflex® Bentonit Expansion Joint Tape | 11,60 € per metre |

KRASOflex® Bentonit Expansion Joint Tape - Accessories **LG 4**

| Type / Item | KRASOflex® Bentonit Expansion Joint Tape - Accessories | |
|--|--|-------------------|
| | Mounting grid | Mounting adhesive |
| Length / Quantity | 1 m | 290 ml |
| KRASOflex® Bentonit Expansion Joint Tape - Accessories | 2.90 € | 22 € |

KRASOflex® Swelling Rubber

Dimensionally stable joint sealing profile

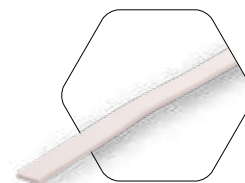

- + For joint sealing in segment construction (precast concrete elements)
- + Joint sealing profile, "dimensionally stable" swelling when in contact with water!
- + For joints in precast concrete elements for use in the construction of basements, tunnels and mine shafts!

KRASOflex® Swelling Rubber **LG 4**

| Type / Item | KRASOflex® Swelling Rubber |
|----------------------------|---------------------------------------|
| Dimension | 20 x 5 mm |
| Packing Unit | 6 metres per roll / 72 metres per box |
| KRASOflex® Swelling Rubber | 8.10 € per metre |

KRASOflex® Mounting Adhesive **LG 4**

| Type / Item | KRASOflex® Mounting Adhesive |
|------------------------------|------------------------------|
| Quantity | 290 ml |
| KRASOflex® Mounting Adhesive | 22 € |



The KRASO® Economy Package - check our samples!

- + Order today:
The **KRASO®** Economy Package for the construction industry contains samples from various product categories of our numerous sealing solutions: sealing inserts, pipe penetrations, joint sealings and many more!
- + +49(0)28 72 - 95 35-0
- + WhatsApp +49(0)28 72 - 95 35-888 
- + export@kraso.de

KRASO®
on the
road



- + The mobile trade fair stand for your event, in-house fairs and promotion days
- + We are pleased to come to you with our **KRASO®** Mobile and to show your customers the **KRASO®** Products and sealing solutions!
- + +49(0)28 72 - 95 35-0
- + WhatsApp +49(0)28 72 - 95 35-888 
- + info@kraso.de



KRASOflex® Joint Tapes

Factory standard, DIN 18541 or DIN 18541 BV

+ Factory standard:

Joint tapes in factory standard quality are made on the basis of PCV-P ("soft PVC").

They are perfectly suited for use in waterproof concrete structures with normal exposure.

Characterised by their excellent workability, weldability and durability, they offer a great price-performance-ratio.

+ DIN 18541:

Joint tapes of this quality level meet the requirements of the German Industry Standard for Thermoplastic joint tapes for sealing joints in concrete. Based on the material PVC-P, a special composition achieves a particular high quality in terms of elasticity, breaking extension and tensile strength. Joint tapes of this quality level are required for construction projects with very high loads.

+ DIN 18541 BV:

Joint tapes of DIN 18541 quality are also optionally available in a bitumen-compatible (BV) version.

KRASOflex®
Joint Tape A

KRASOflex®
Joint Tape AD

KRASOflex®
Joint Tape AA

KRASOflex®
Joint Tape ASI

KRASOflex®
Joint Tape D

WU
1+2

NEW BUILDING

KRASOflex® Joint Tapes

Factory standard, DIN 18541 or DIN 18541 BV

- + Internal and external construction and expansion joint tapes
- + Further joint tapes are available on request!
- + DafStB waterproof concrete guideline: stress class 1 + 2



KRASOflex® Joint Tape A **LG 4**

internal construction joint tape



| Type / Item | KRASOflex® A 120 | KRASOflex® A 150 | KRASOflex® A 200 | KRASOflex® A 240 | KRASOflex® A 320 |
|---|--------------------|--------------------|---------------------|-------------------|-------------------|
| Profile width | 120 mm | 150 mm | 200 mm | 240 mm | 320 mm |
| Roll length | 25 m | 25 m | 25 m | 25 m | 25 m |
| KRASOflex® Joint Tape A (factory standard) | 5.30 € per metre | 6.40 € per metre | 7.90 € per metre | 9.10 € per metre | 13.50 € per metre |
| KRASOflex® Joint Tape A (according to DIN 18541) | 7.50 € per metre * | 8.50 € per metre * | 11.80 € per metre * | 13.60 € per metre | 20.40 € per metre |

* according to DIN 18541, part 2

BV (bitumen-compatible) available at an additional charge!



KRASOflex® Joint Tape ASI **LG 4**

internal construction joint tape, inside stabilised (factory standard)



| Type / Item | KRASOflex® ASI 120 | KRASOflex® ASI 150 | KRASOflex® ASI 200 | KRASOflex® ASI 240 | KRASOflex® ASI 320 |
|---------------------------|--------------------|--------------------|--------------------|--------------------|--------------------|
| Profile width | 120 mm | 150 mm | 200 mm | 240 mm | 320 mm |
| Roll length | 25 m | 25 m | 25 m | 25 m | 25 m |
| KRASOflex® Joint Tape ASI | 6.30 € per metre | 7.20 € per metre | 8.40 € per metre | 10.40 € per metre | 14.90 € per metre |

BV (bitumen-compatible) available at an additional charge!

KRASOflex® Joint Tape AA **LG 4**

external construction joint tape,
available in factory standard, DIN 18541 and DIN 18541 BV



| Type / Item | KRASOflex® Joint Tape AA 240 | KRASOflex® Joint Tape AA 320 |
|---|------------------------------|------------------------------|
| Profile width | 240 mm | 320 mm |
| Standard anchor height | 20 mm | 25 mm |
| Roll length | 25 m | 25 m |
| KRASOflex® Joint Tape AA (factory standard) | 13.60 € per metre | 19.60 € per metre |
| KRASOflex® Joint Tape AA (35 mm anchor) | 17.70 € per metre | 23.90 € per metre |
| KRASOflex® Joint Tape AA (according to DIN 18541) | 16.90 € per metre | 24.50 € per metre |
| KRASOflex® Joint Tape AA (35 mm anchor, according to DIN 18541) | 22.10 € per metre | 30.30 € per metre |

BV (bitumen-compatible) available at an additional charge!

KRASOflex® Joint Tape AD **LG 4**

external expansion joint tape,
available in factory standard, DIN 18541 and DIN 18541 BV

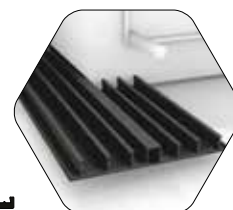

| Type / Item | KRASOflex® Joint Tape AD 240 | KRASOflex® Joint Tape AD 320 |
|---|------------------------------|------------------------------|
| Profile width | 240 mm | 320 mm |
| Standard anchor height | 20 mm | 25 mm |
| Roll length | 25 m | 25 m |
| KRASOflex® Joint Tape AD (factory standard) | 15.80 € per metre | 20.70 € per metre |
| KRASOflex® Joint Tape AD (35 mm anchor) | 19.60 € per metre | 25 € per metre |
| KRASOflex® Joint Tape DA (according to DIN 18541) | 19.50 € per metre | 25.90 € per metre |
| KRASOflex® Joint Tape DA (35 mm anchor, according to DIN 18541) | 24.40 € per metre | 31.50 € per metre |

BV (bitumen-compatible) available at an additional charge!

KRASOflex® Joint Tape D **LG 4**

internal expansion joint tape,
available in factory standard, DIN 18541 and DIN 18541 BV



| Type / Item | KRASOflex® Joint Tape D 240 | KRASOflex® Joint Tape D 320 |
|--|-----------------------------|-----------------------------|
| Profile width | 240 mm | 320 mm |
| Roll length | 25 m | 25 m |
| KRASOflex® Joint Tape D (factory standard) | 13.40 € per metre | 17.90 € per metre |
| KRASOflex® Joint Tape D (according to DIN 18541) | 16.40 € per metre | 22.30 € per metre |

BV (bitumen-compatible) available at an additional charge!



KRASOflex® Joint Tapes

for building expansion joints and construction joints

+ DafStB waterproof concrete guideline: stress class 1 + 2

KRASOflex® Building Expansion Joint T1

base plate and wall separate
corner moulding: external expansion joint tape type AD 320 (under the base plate) on external expansion joint tape type AD 320 (wall) and on **KRASOflex® Duo-Fix 150 „plus“** as connection piece for surrounding **KRASOflex® Duo-Fix 150 „plus“**, anchor lengths 50 cm each (expansion joint tapes according to factory standard, DIN 18541 and DIN 18541 BV)

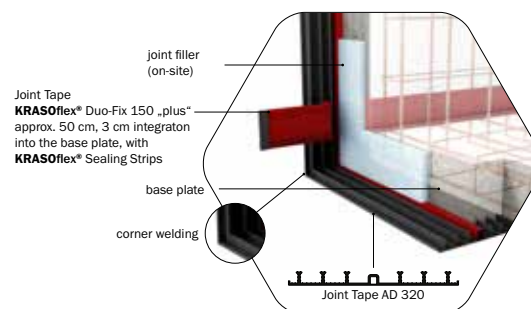

| Type / Item | KRASOflex® Building Expansion Joint T1 |
|--|--|
| KRASOflex® Building Expansion Joint T1 | Prices on request |

Scope of supply: KRASOflex® Building Expansion Joint T1 incl. 2 KRASOflex® Mounting Clamps

KRASOflex® Building Expansion Joint T2

base plate and wall separate
corner moulding: external expansion joint tape type AD 320 (under the base plate), on internal expansion joint tape type D 320 (wall), and on **KRASOflex® Duo-Fix 150 „plus“** as connection piece, for surrounding **KRASOflex® Duo-Fix 150 „plus“**, anchor length 50 cm each (expansion joint tapes according to factory standard and DIN 18541)

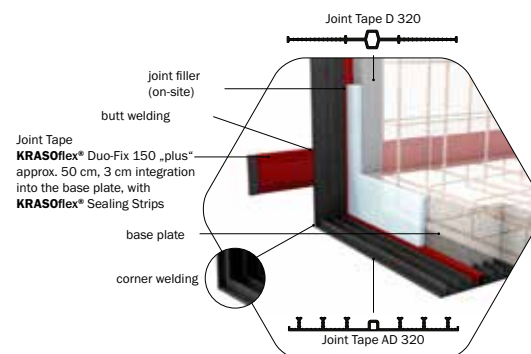

| Type / Item | KRASOflex® Building Expansion Joint T2 |
|--|--|
| KRASOflex® Building Expansion Joint T2 | Prices on request |

Scope of supply: KRASOflex® Building Expansion Joint T2 incl. 2 KRASOflex® Mounting Clamps

KRASOflex® Construction Joint T3

base plate and wall continuous
corner moulding: external construction joint tape type AA 320 (under the base plate)
on external construction joint tape Type AA 320 (wall), and on **KRASOflex® Duo-Fix 150 „plus“** as connection piece for surrounding **KRASOflex® Duo-Fix 150 „plus“**, anchor length 50 cm each (construction joint tapes according to factory standard, DIN 18541 and DIN 18541 BV)

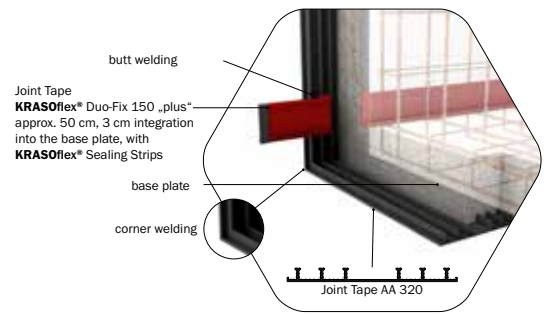

| Type / Item | KRASOflex® Construction Joint T3 |
|----------------------------------|----------------------------------|
| KRASOflex® Construction Joint T3 | Prices on request |

Scope of supply: KRASOflex® Construction Joint T3 incl. 2 KRASOflex® Mounting Clamps

KRASOflex® Wall Expansion Joint T4

base plate continuous and separate wall
corner moulding: internal expansion joint tape type D 320 (wall) with anchor sections to attach the surrounding **KRASOflex® Duo-Fix 150 „plus“** (expansion joint tapes according to factory standard and DIN 18541)

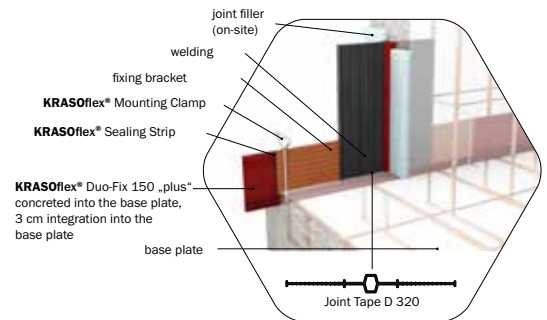

| Type / Item | KRASOflex® Wall Expansion Joint T4 |
|------------------------------------|------------------------------------|
| KRASOflex® Wall Expansion Joint T4 | Prices on request |

Scope of supply: KRASOflex® Wall Expansion Joint T4 incl. 2 KRASOflex® Mounting Clamps

KRASOflex® Building Expansion Joint T5

base plate and separate wall
corner moulding: external expansion joint tape type AD 320 (under the base plate)
on external expansion joint tape Type AD 320 Corner A (wall), and on **KRASOflex® Duo-Fix 150 „plus“** as connection piece, for surrounding **KRASOflex® Duo-Fix 150 „plus“**, anchor lengths 50 cm each (expansion joint tapes according to factory standard, DIN 18541 and DIN 18541 BV)

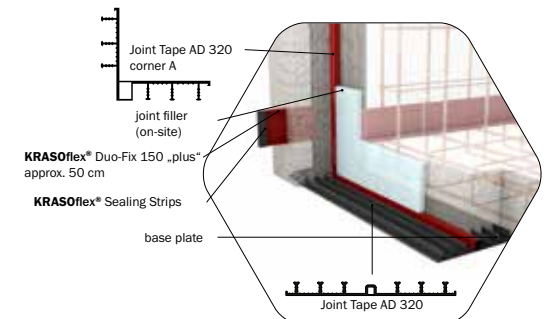

| Type / Item | KRASOflex® Building Expansion Joint T5 |
|--|--|
| KRASOflex® Building Expansion Joint T5 | Prices on request |

Scope of supply: KRASOflex® Building Expansion Joint T5 incl. 2 KRASOflex® Mounting Clamps

KRASO® Construction Joint T6

base plate continuous, joint area of triple wall (desired crack)
corner moulding: external construction joint tape type AA 320 (under the base plate), on external construction joint tape type AA 320 (wall) and on **KRASOflex® Duo-Fix 150 „plus“** as connection piece for surrounding **KRASOflex® Duo-Fix 150 „plus“** and for adding **KRASOflex® Star Tube System FTW 60** (must be ordered separately), anchor lengths 50 cm each (construction joint tapes according to factory standard, DIN 18541 and DIN 18541 BV)

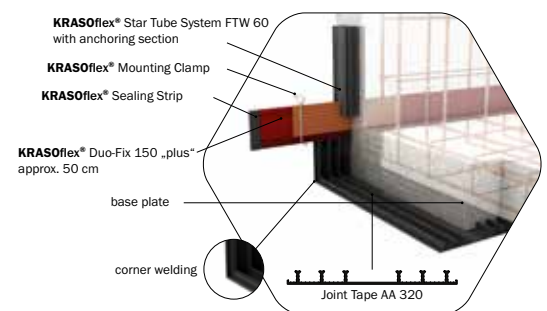

| Type / Item | KRASOflex® Construction Joint T6 |
|----------------------------------|----------------------------------|
| KRASOflex® Construction Joint T6 | Prices on request |

Scope of supply: KRASOflex® Construction Joint T6 incl. 2 KRASO® Mounting Clamps



KRASOflex®
Clamp Construction - external

external expansion joint tape
DA 330/35 according to DIN 18541
new element to existing element

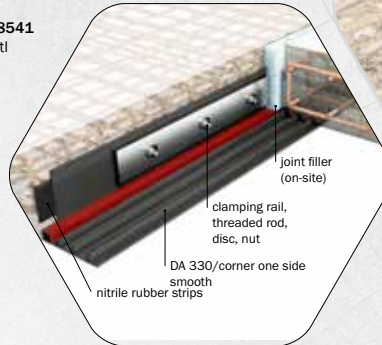

KRASOflex®
Clamp Construction - internal



KRASOflex® Clamp Constructions

For the connection of new elements to existing elements

- + Clamp Constructions in stainless steel or galvanised. Internal and external.
- + DafStB waterproof concrete guideline: stress class 1 + 2

KRASOflex® Clamp Constructions **LG 4**

| Type / Item | KRASOflex® Clamp Construction | | | |
|--|-------------------------------|--------------|--------------------|---------------------|
| Clamping bar flat steel (non-corrosive stainless steel V2A or galvanised, length approx. 1.20 m with slotted hole every 15 cm) | 80 x 8 mm | | | |
| Nitrile rubber strips | 80 x 3 mm | | | |
| Shear connector cartridges | M12 | | | |
| Threaded rods (non-corrosive stainless steel V2A or galvanised) | M12 x 160 mm | | | |
| Design Joint Tape / Clamping bar flat steel | D 330 / V2A | DA 330 / V2A | D 330 / galvanised | DA 330 / galvanised |
| KRASOflex® Clamp Construction | 195 € | 198 € | 165 € | 168 € |

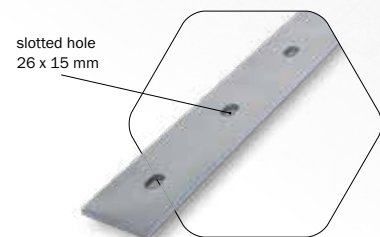

KRASOflex® Clamp Constructions - Accessories **LG 4**

| Type / Item | KRASOflex® Clamp Constructions - Accessories | | | | |
|---|---|--|--|--------------------------|-----------------|
| | Flat steel clamp rail galvanised length approx. 1.20 m with slotted hole every 15 cm | Flat steel clamp rail V2A length approx. 1.20 m with slotted hole every 15 cm | Flat steel clamp rail V4A length approx. 1.20 m with slotted hole every 15 cm | Internal corner | External corner |
| | 80 x 8 mm | 80 x 8 mm | 80 x 8 mm | | |
| KRASOflex® Clamp Constructions - Accessories | Prices on request | | | | |
| Type / Item | KRASOflex® Clamp Constructions - Accessories | | | | |
| | Nitrile rubber strip | Shear connector cartridges | Threaded rods non-corrosive stainless steel V2A or galvanised | Clamp protection profile | |
| | 80 x 3 mm | M12 | M12 x 160 mm | | |
| KRASOflex® Clamp Constructions - Accessories | Prices on request | | | | |